



Speedwell Close, Cambridge, CB1 9YS

CHEFFINS

Speedwell Close

Cambridge,
CB1 9YS

A well presented one bedroom first floor apartment located in Cherry Hinton with excellent access to the city centre. The property benefits from secured entry and allocated parking space. Available 22nd September 2025.

- Once Bedroom
- Kitchen
- Shower Room
- EPC Rating C
- Council Tax Band B
- Minimum 12 Month Tenancy



£1,150 PCM





Entrance Hall

Living Room

Window, door to:

Kitchen

Fitted wall and base units with worktop over, sink with mixer tap and drainer, electric cooker, space for appliances

Bedroom

Window, wardrobe

Shower Room

Shower cubicle, wc, wash hand basin

Parking

1 Allocated parking space

Holding Deposit

£265

Material Information

For more information on this property please refer to the Material Information brochure on our Website



Energy Efficiency Rating

	Current	Potential
Very energy efficient - lower running costs		
(92 plus) A		
(81-91) B		
(69-80) C	77	84
(55-68) D		
(39-54) E		
(21-38) F		
(1-20) G		
Not energy efficient - higher running costs		
England & Wales	EU Directive 2002/91/EC	

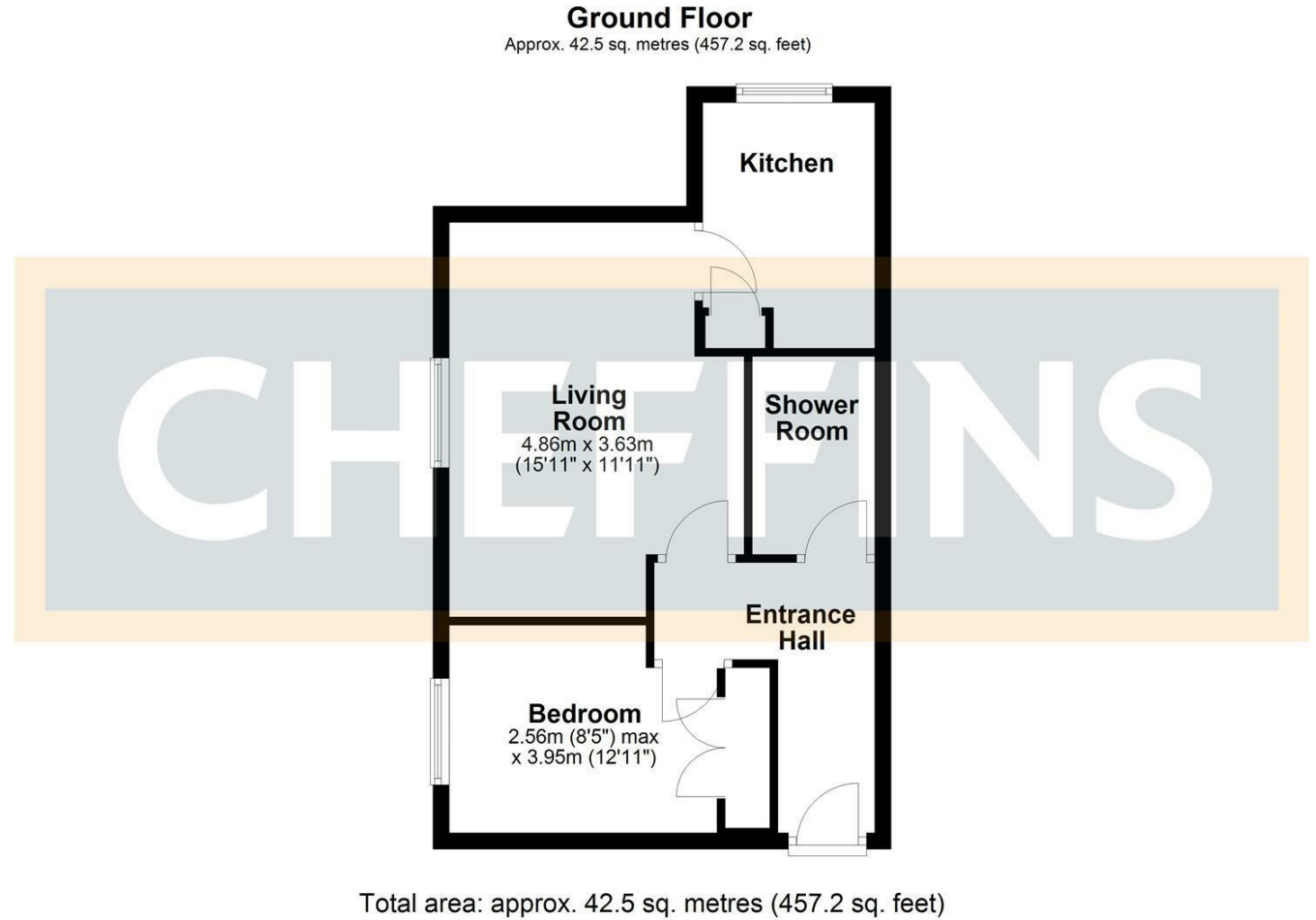

Agents note:

For more information on this property please refer to the Material Information Brochure on our website.

Cavendish House, 27a High Street, Haverhill, Suffolk, CB9 8AD | 01440 707076 | cheffins.co.uk

IMPORTANT: we would like to inform prospective purchasers that these sales particulars have been prepared as a general guide only. A detailed survey has not been carried out, nor the services, appliances and fittings tested. Room sizes should not be relied upon for furnishing purposes and are approximate. If floor plans are included, they are for guidance only and illustration purposes only and may not be to scale. If there are any important matters likely to affect your decision to buy, please contact us before viewing the property.

